

# 4W/S SERIES

## 3½ DIGIT ADJUSTABLE VOLTAGE INPUT LCD DPM INSTALLATION SHEET

### PANEL CUTOUT & DIMENSIONS

#### WINDOW / SURFACE MOUNTING

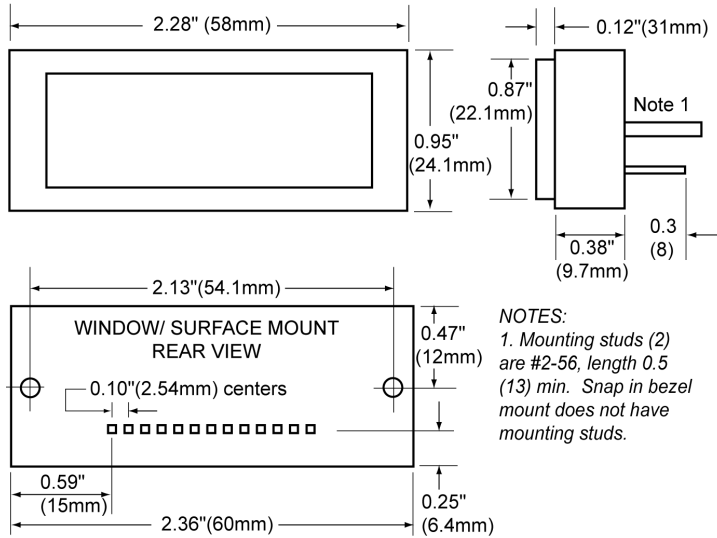

#### SNAP-IN BEZEL MOUNTING

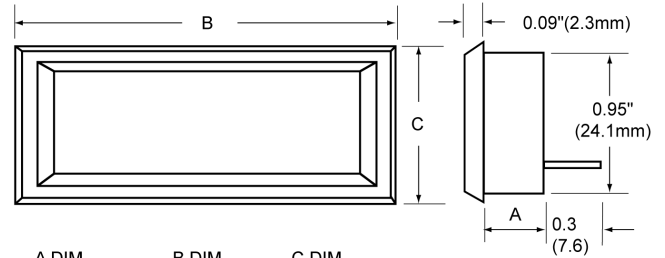

A DIM.	B DIM.	C DIM.
0.44"(11.2mm)	2.51"(63.8mm)	1.10"(28mm)

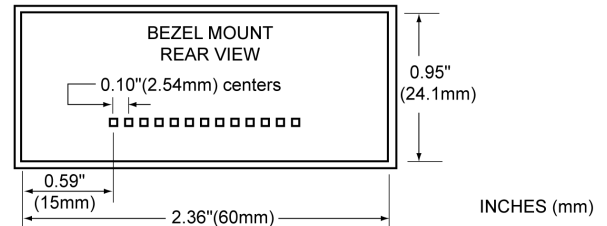

#### SURFACE MOUNTING

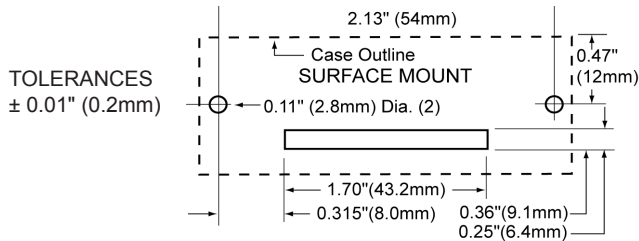

#### SNAP-IN BEZEL MOUNTING

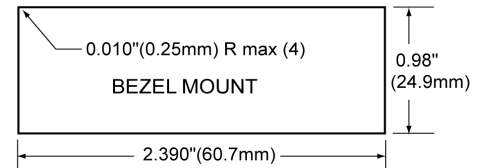

#### WINDOW MOUNTING

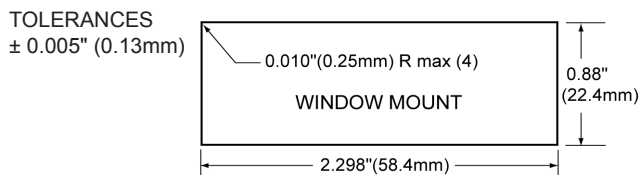

#### WIRING CONNECTION DESCRIPTIONS

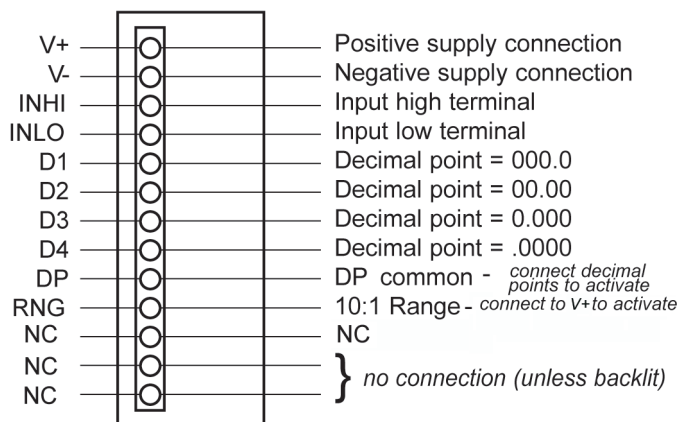

\*For single ended 5V power operation: V- should be connected to INLO